



# Steering Gearbox

## Gearbox Removal

NOTE: Before removing the steering gearbox, align the front wheels straight ahead.

1. Drain the power steering fluid as described on page 17-18.
2. Raise the front of car and support on safety stands in the proper locations (see section 1).
3. Remove the front wheels.
4. Remove the cotter pin from the castle nut and remove the nut.
5. Install the 12 mm hex nut on the ball joint. Be sure that the 12 mm hex nut is flush with the ball joint pin end, or the threaded section of the ball joint pin might be damaged by the ball joint remover.

NOTE: Remove the ball joint using the Ball Joint Remover, 28 mm (07MAC-SL00200). Refer to page 18-12 for how to use the ball joint remover.

6. Separate the tie-rod ball joint and knuckle using the special tool.

**CAUTION:** Avoid damaging the ball joint boot.

BALL JOINT REMOVER, 28 mm  
07MAC-SL00200

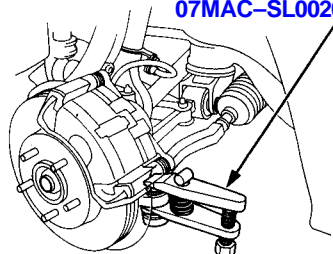

7. Loosen the steering joint bolts.

NOTE: Do not remove the bolt at this time.

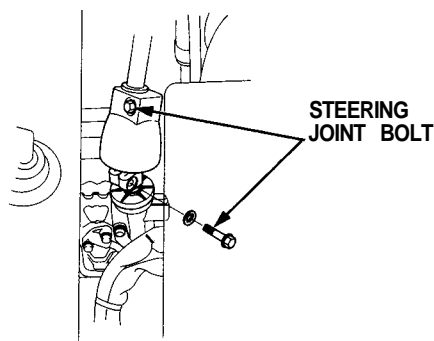

**CAUTION:** Some splash guard mounting bolts are also used as gearbox mounting bolts. The gearbox will tilt to the side when these bolts are removed. Be sure to remove the joint bolt when lowering the gearbox.

8. Remove the splash guard.

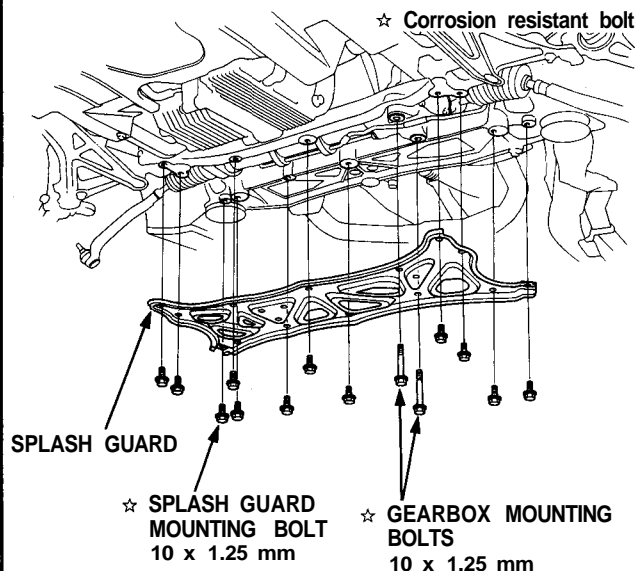

9. Using solvent and a brush, wash any oil and dirt off the valve body unit, its lines, and the end of the gearbox. Blow dry with compressed air.
10. Remove the hoses from the hose clamp on the right side.
11. Disconnect the four lines from the valve body unit.

RETURN LINE (6 mm)

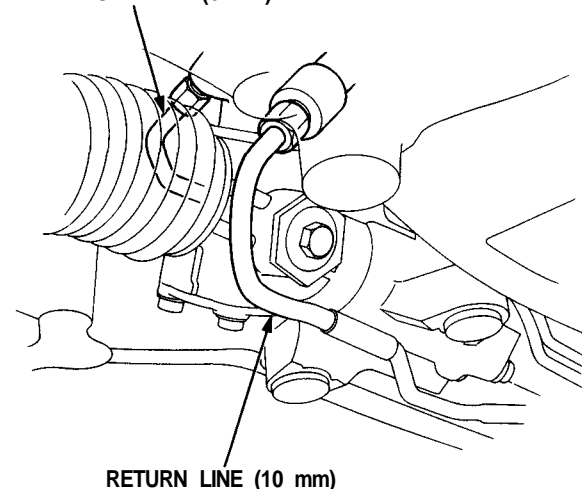

(cont'd)

# Steering Gearbox

## Gearbox Removal (cont'd)

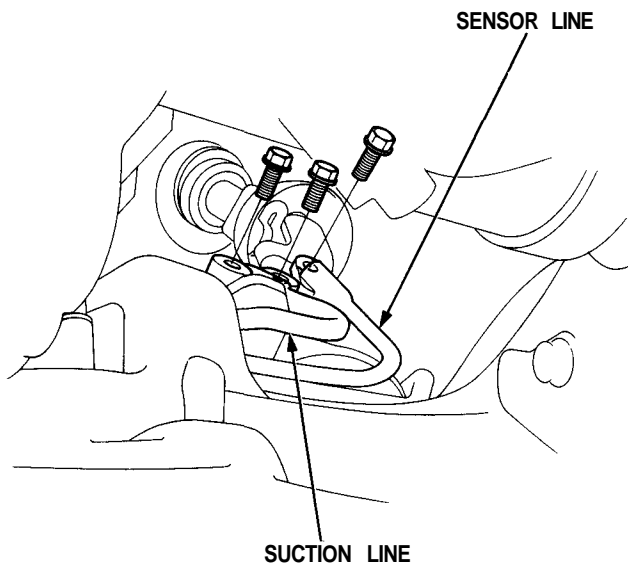

12. Remove the pipe clamps from the gearbox.

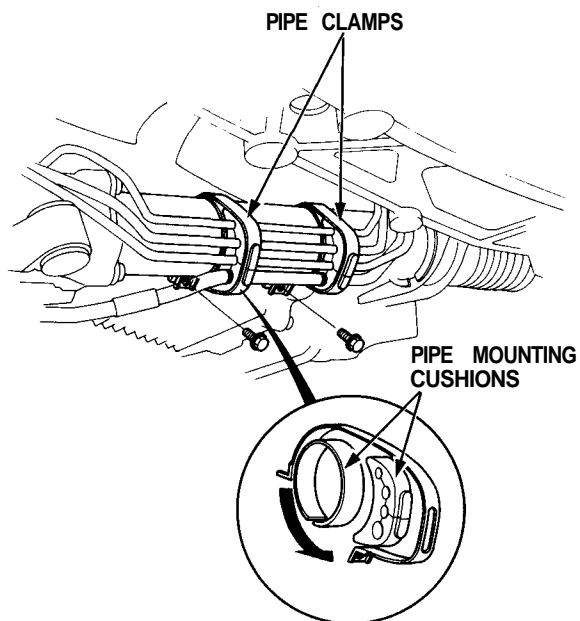

13. Separate the gearbox pinion shaft and steering joint by removing the steering joint bolt.

NOTE: Before removing the gearbox, place a safety stands under the gearbox.

14. Remove the gearbox mounting bolts and gearbox assembly.

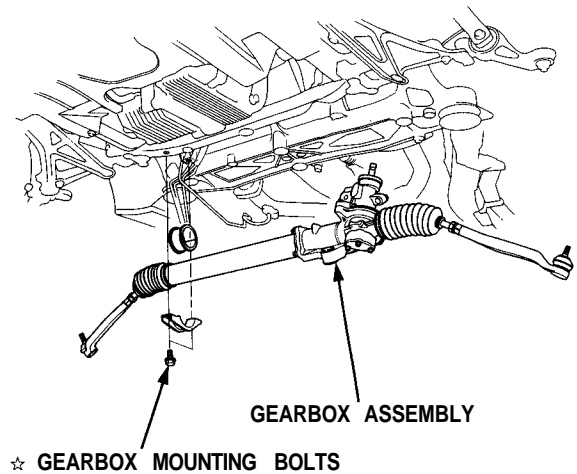

☆ Corrosion resistant bolt